

PENN STATION TRANSFORMATION

New York Penn Station Working Advisory Group (SWAG)

Tuesday, November 19, 2024

Safety and Security Moment



Emergency Preparedness

Our physical address is 383 West 31st Street.

Who will call 911, and who is their backup?

Who is CPR/AED qualified?

Know the location of emergency equipment.



Evacuation

Communicate the need to evacuate.

Follow the Facility Emergency Plan (FEP).

Know your evacuation plan/ route & muster point.

Assist those who may need help evacuating.

Wait for permission to re-enter the facility.



Safety Reporting

Proactively identify & report unsafe conditions or behaviors.

Use AVSRS through the Safety page on All Aboard or download the Enablon Go mobile app.

Report all safety concerns.



Health and Wellbeing

Take healthy actions:

Physical Activity

Healthy Nutrition

Adequate Sleep

Mental Well-being

Stay up to date with preventive services.

Take time to refresh & recharge.



Security

If You See Something, Say Something®. Call 800-331-0008 / text 27311.

Active Shooter: Run, Hide, Fight.

Always be aware of surroundings.

Display and verify proper ID on Amtrak property.



Cybersecurity

Pay attention to phishing traps in emails.

Don't click on links or attachments from unknown sources.

Report all suspicious email and cyber incidents to the Amtrak Service Desk:

800-772-4357
AmtrakServiceDesk@amtrak.com

Agenda

- Meeting Goals
- Initial Group Activity
- Penn Reconstruction Design Update
 - Path to Preliminary Engineering
 - Preliminary Engineering Update
- Penn Projects Preliminary Timelines
- Discussion & Feedback
- Penn Station Tour (Optional)

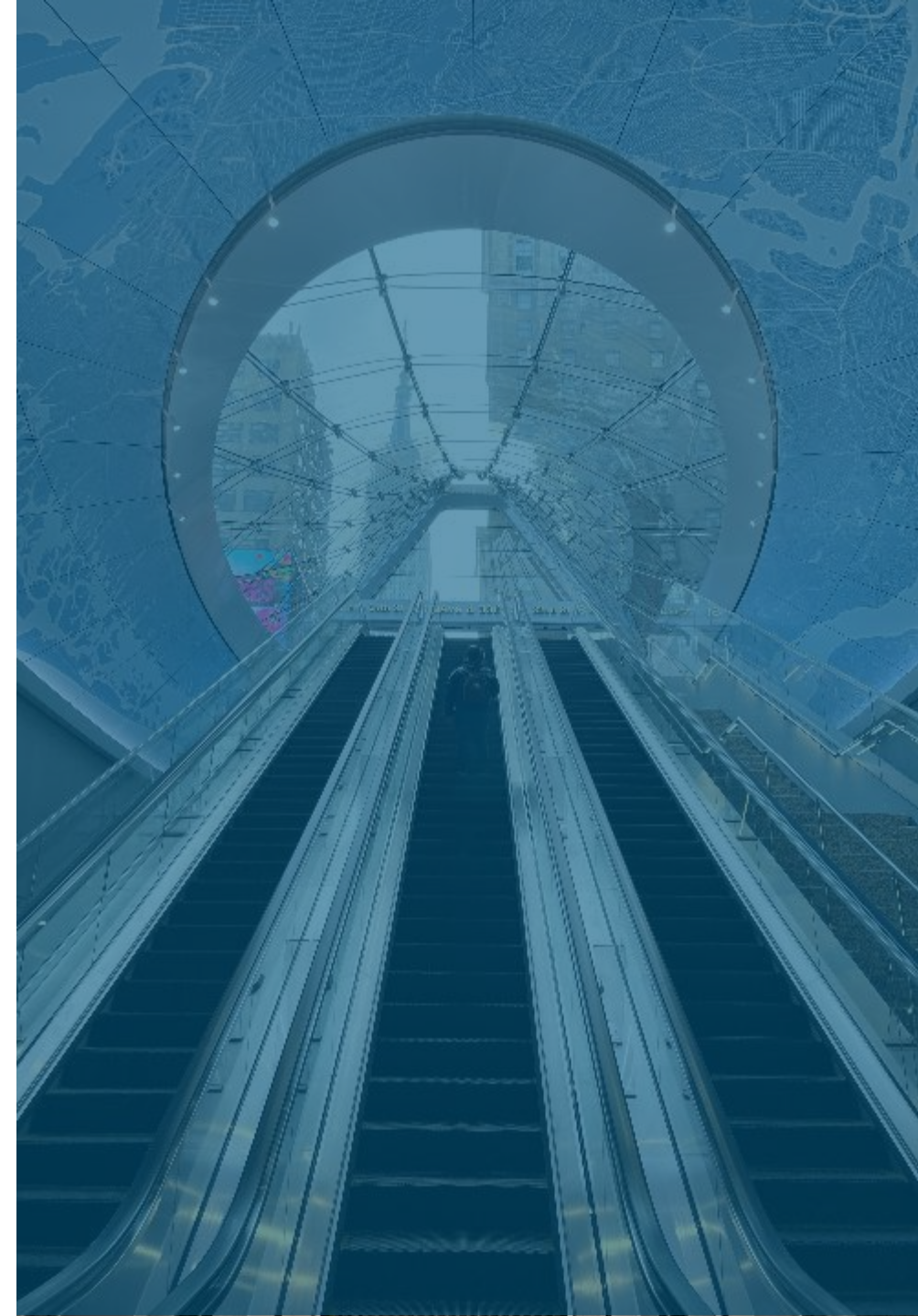

Meeting Goals

Provide update on Penn Reconstruction preliminary engineering work, describing learnings and design evolution since earlier Penn Station Master Plan study

Gather initial feedback on proposed station improvements

Share preliminary timelines for both Penn Projects

Tour Penn Station to enhance understanding of challenges and proposed improvements

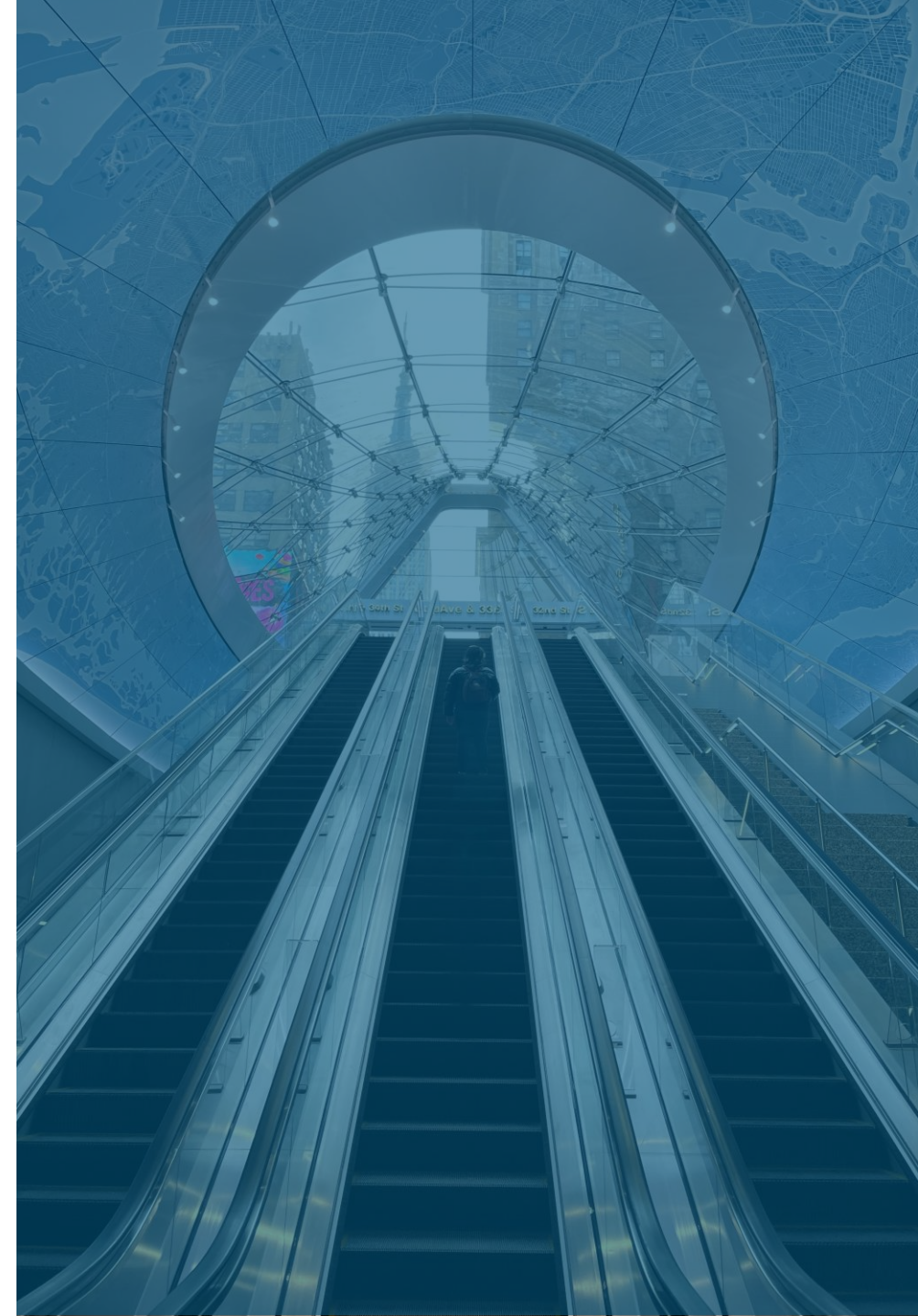

Initial Activity – Group Poll

What do you appreciate about Penn Station today?

What do you think is the most critical improvement needed?

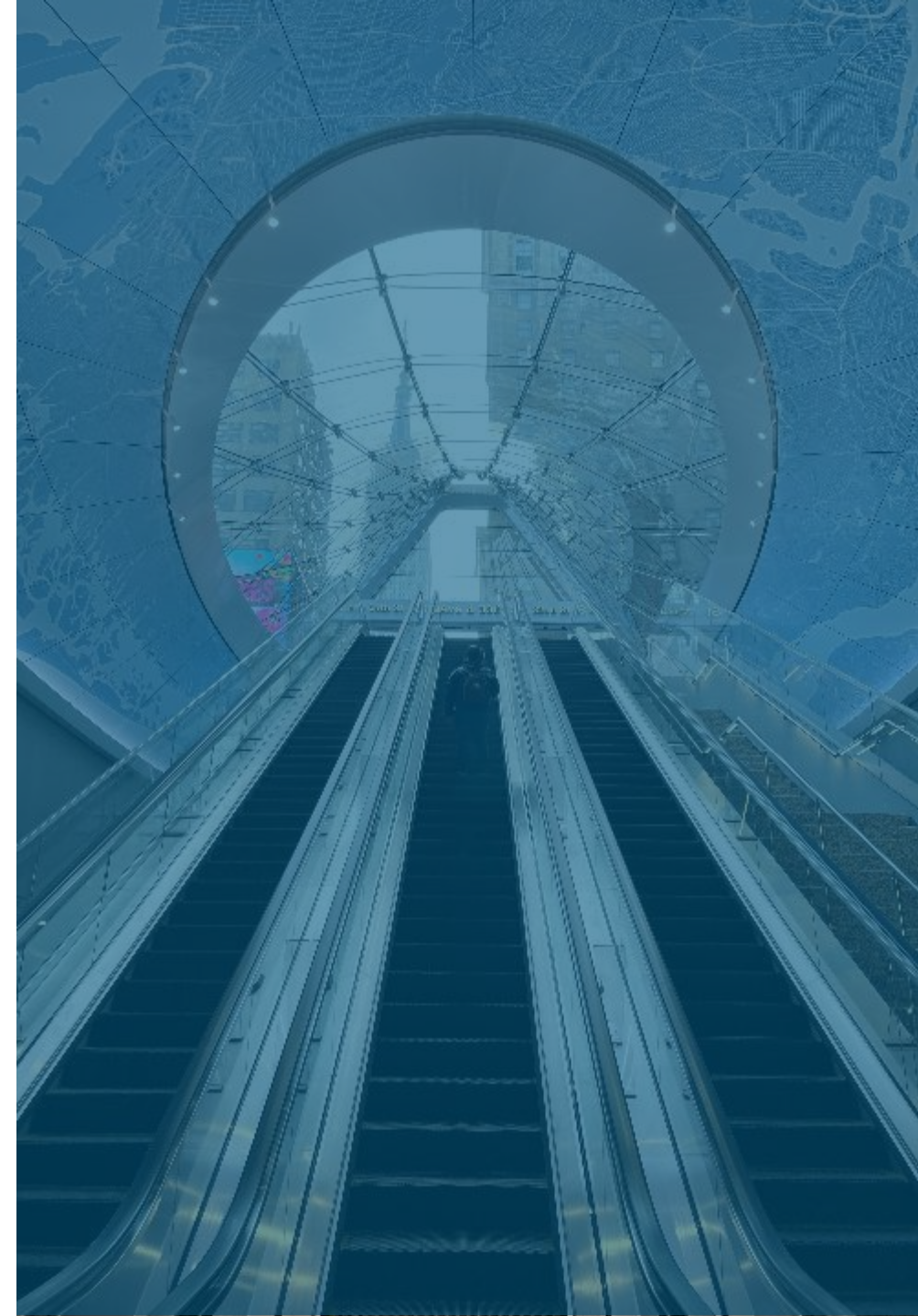

32 responses submitted

What do you appreciate about Penn Station today?



Wordcloud

All responses



1 of 2



What do you think is the most critical improvement needed?



Wordcloud All responses



PENN RECONSTRUCTION

Path to Preliminary Engineering

Current Station Challenges: Project Need



Inadequate Platform Egress



Severe Crowding



Inadequate Station Egress & Accessibility



Limited Street Presence

User Experience



Confusing Layout with Low Ceilings

Crowding and Safety



Underperforming Equipment & Systems

Outdated Building Systems and Inefficient Operations

Penn Station Existing Layout

Lower Level (Level A)

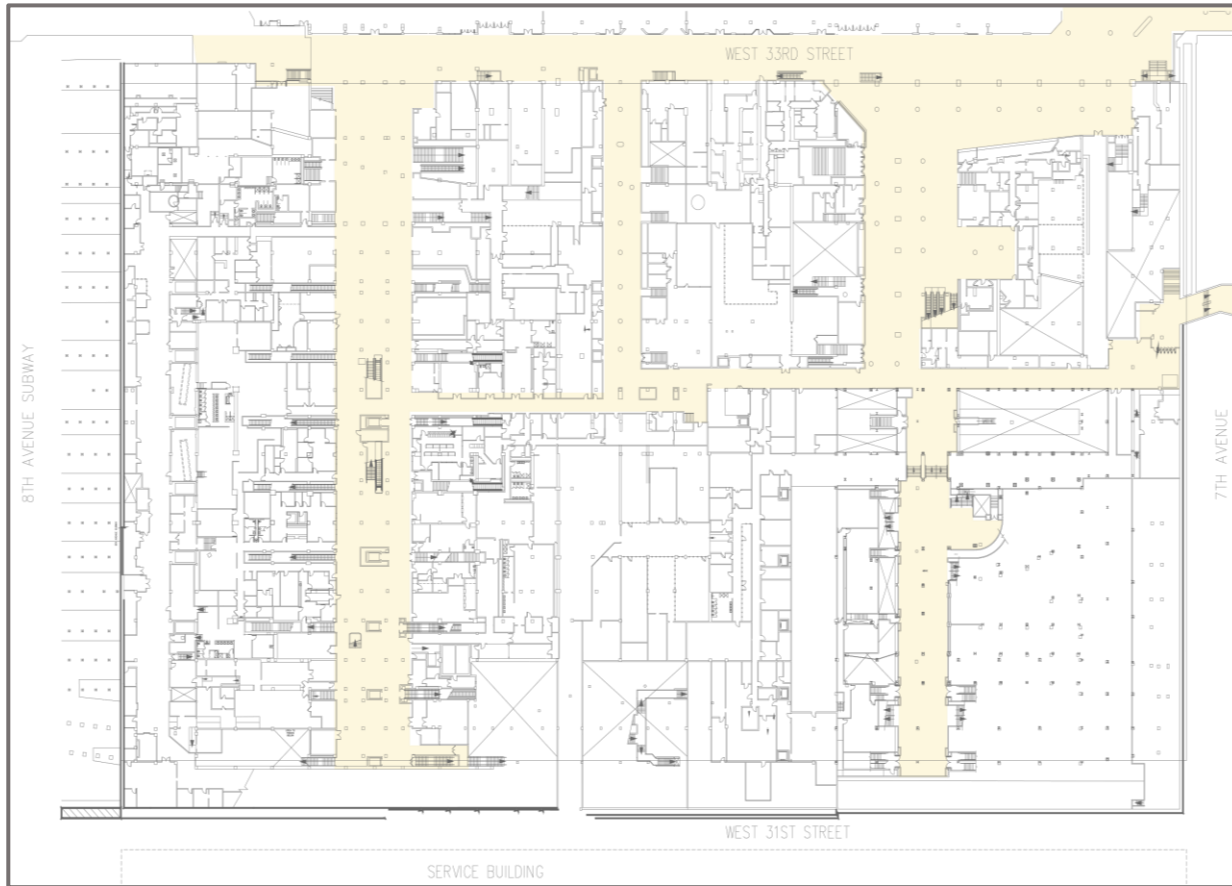

Upper Level (Level B)

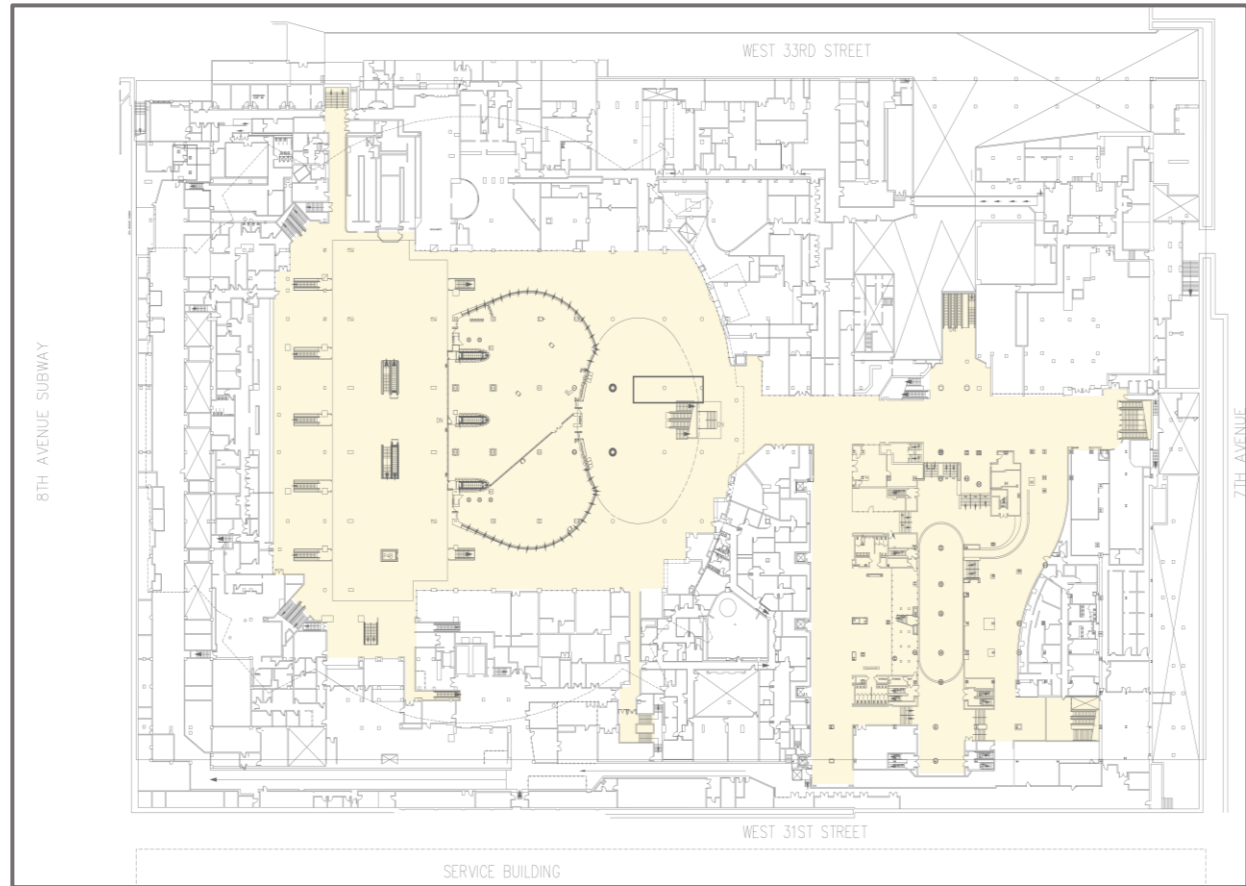

Penn Station Master Plan

Inter-agency study initiated by Railroad Partners in 2019 to develop framework for **improving existing station experience and operations**

Consensus reached on reconstruction principles, including:

- Transitioning to a **single-level** customer experience
- Prioritizing **vertical circulation, accessibility, and egress improvements**
- **Unifying customer experience** and rationalizing station operations
- **Modernizing** facility equipment and systems

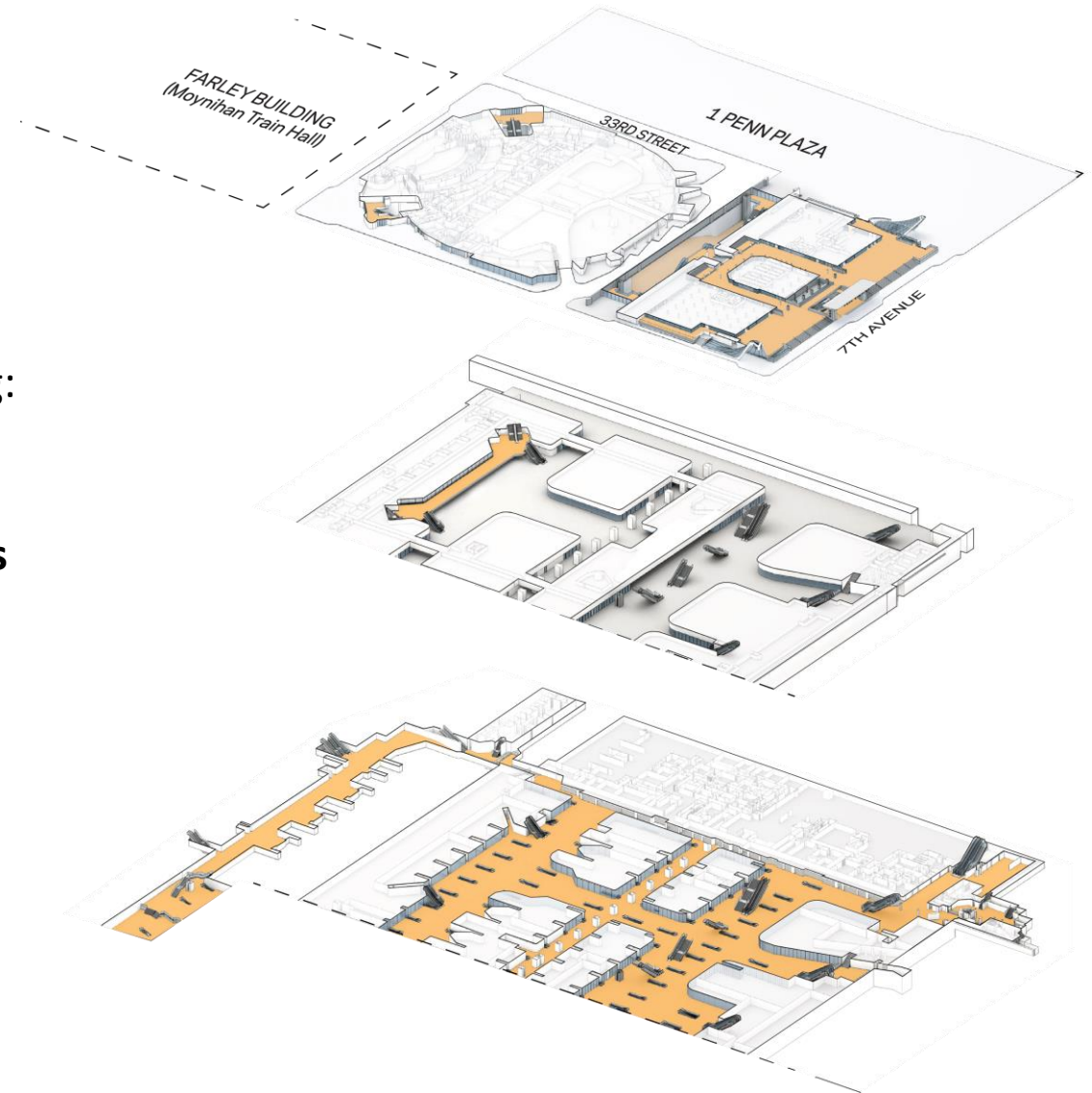



PENN RECONSTRUCTION

Preliminary Engineering Update

From Master Plan to Preliminary Engineering



Sharpened focus on top goals of improving safety, functionality, and overall customer experience



Found significant mechanical equipment footprint required to install modern heating, ventilation, air conditioning, and other critical building systems



Uncovered additional structural complexity in Station interior



Updated pedestrian movement studies and modeling highlighted changing patterns in district and projected greatest volumes along 7th and 8th Avenues and concourses mirroring those avenues



Balanced tradeoffs between maximizing station public circulation space and accommodating critical railroad operational functions



Planned thoughtfully to ensure ability to **maintain station operations and service** during construction and **optimize construction cost**

Inspirational Precedents

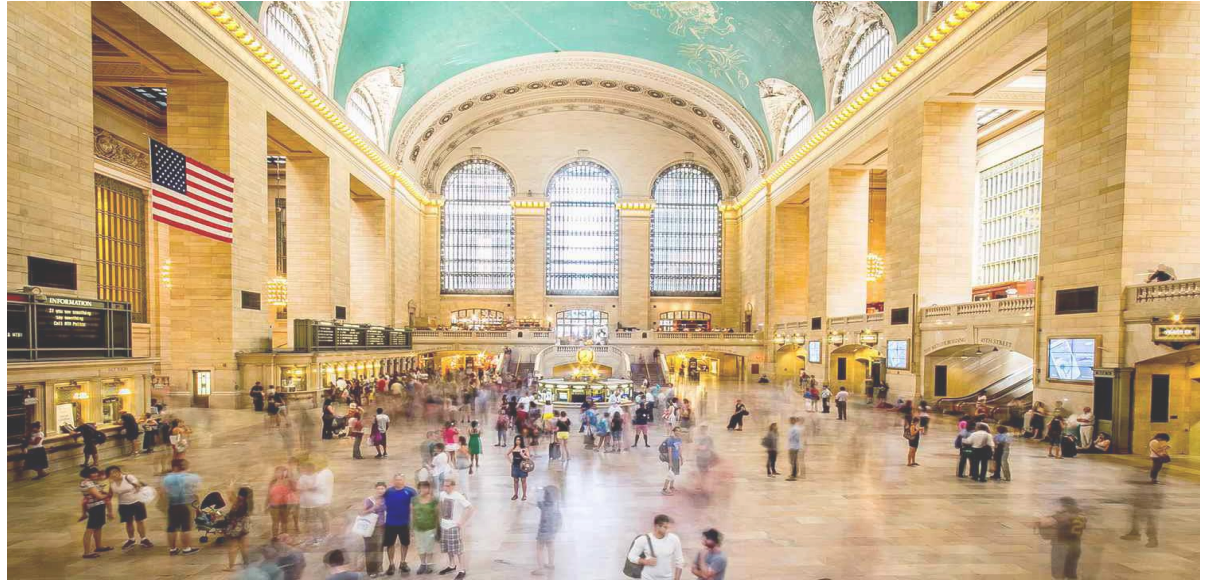

Refined Proposed Project Elements

Underground Concourses



Platform Accessibility
Maximized and rationalized platform vertical circulation layout

Concourses
Widened, double-height concourses with improved legibility and egress

Street Level

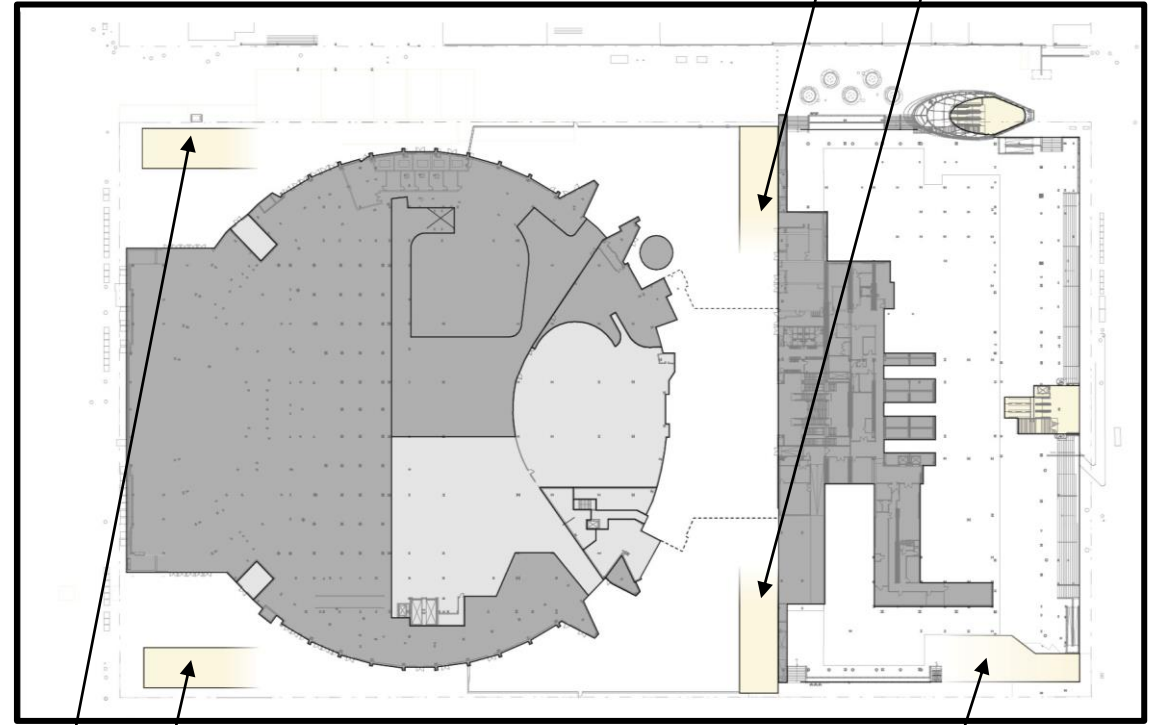

New Mid-Block Entrances
Improving accessibility and egress and supporting new mechanical equipment

8th Ave Entrances
Accessibility and egress improvements with structures to support mechanical equipment

31st/7th Ave Entrance
Accessibility, egress, and mechanical improvements

Proposed Platform Improvements

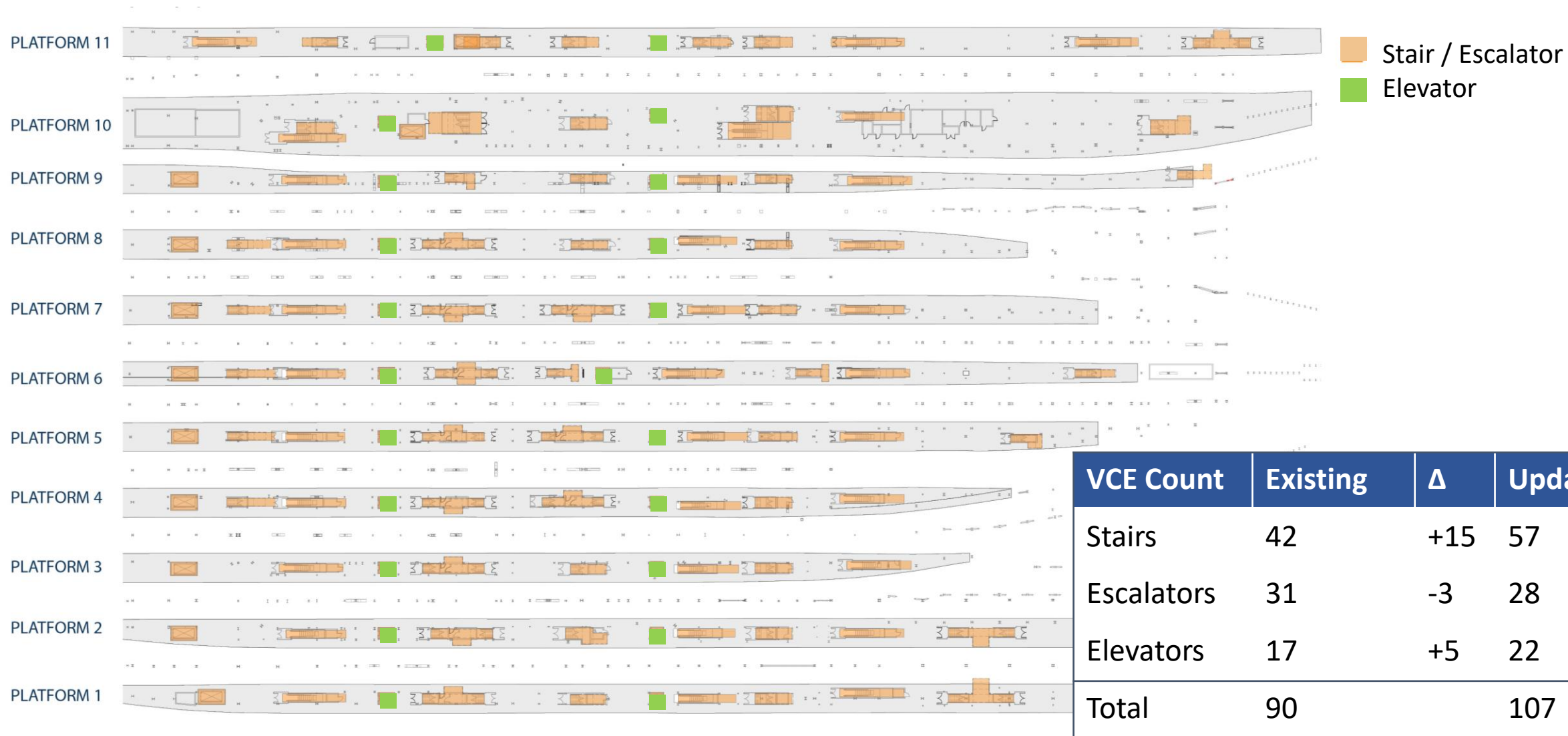

VCE Count	Existing	Δ	Update
Stairs	42	+15	57
Escalators	31	-3	28
Elevators	17	+5	22
Total	90		107

Proposed Concourse Improvements

- Spacious boarding/alighting areas on single level
- Public circulation space increased by 60%
- Rationalized concourse layout mirroring street grid
- 30% more vertical circulation elements to platforms
- Ceiling heights increased to 16-18' minimum
- Co-located railroad Customer Services
- Spacious consolidated waiting areas and restrooms
- Modern retail amenities

Lower Level (Level A)



- Restrooms
- Waiting Areas
- Customer Service
- Circulation

Concourse Layout Comparison



Today

Lower Level (Level A)



Proposed Post-Reconstruction

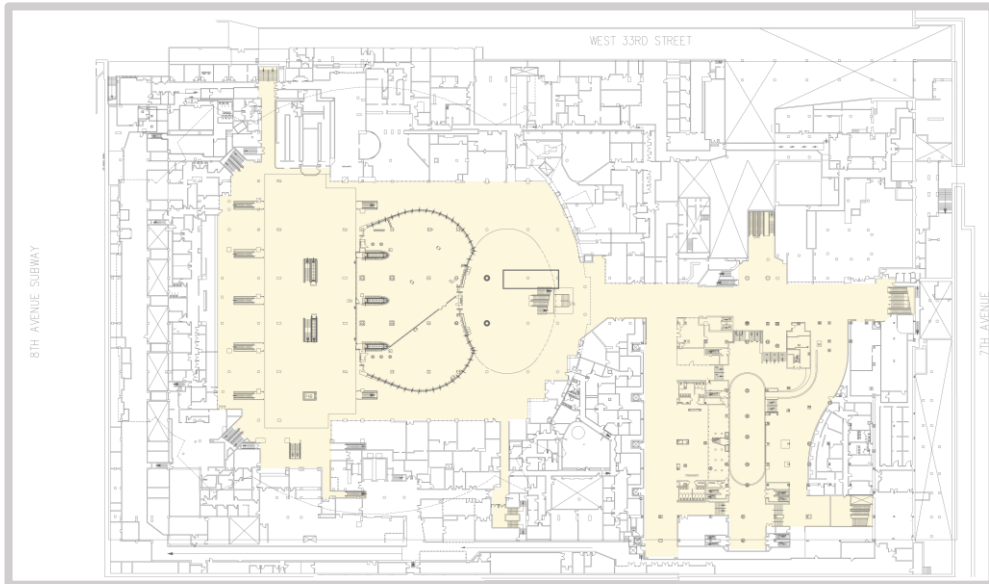

Today

Upper Level (Level B)



Proposed Post-Reconstruction

Proposed Concourse Space

Increased public circulation area for more spacious boarding and alighting experience

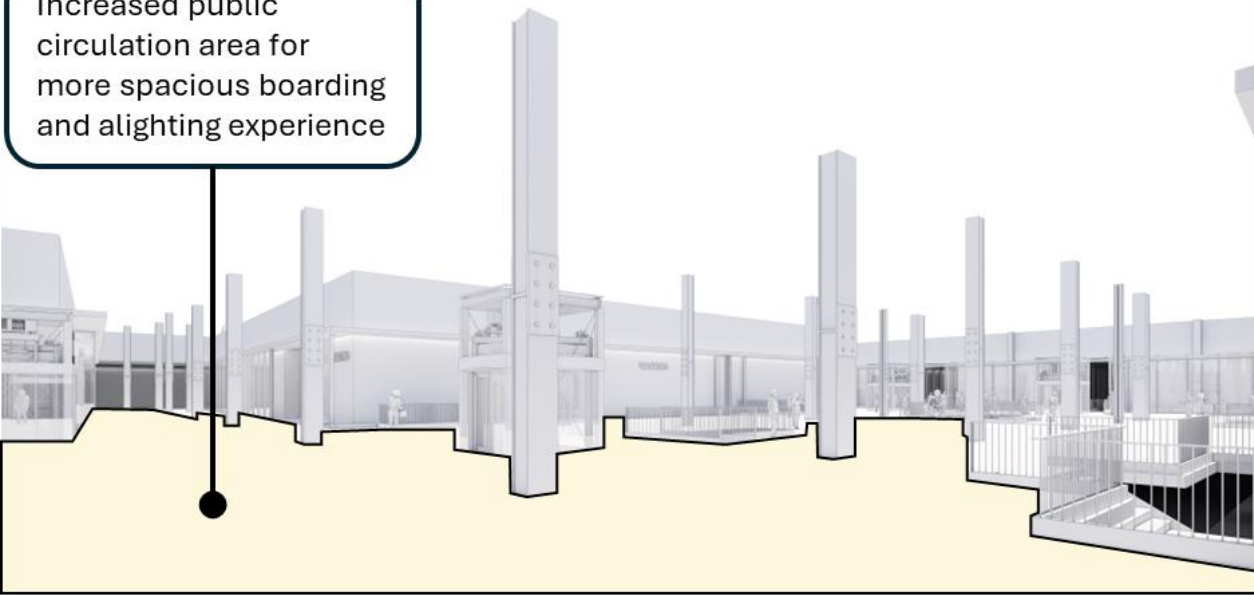

Increased ceiling heights in public circulation areas

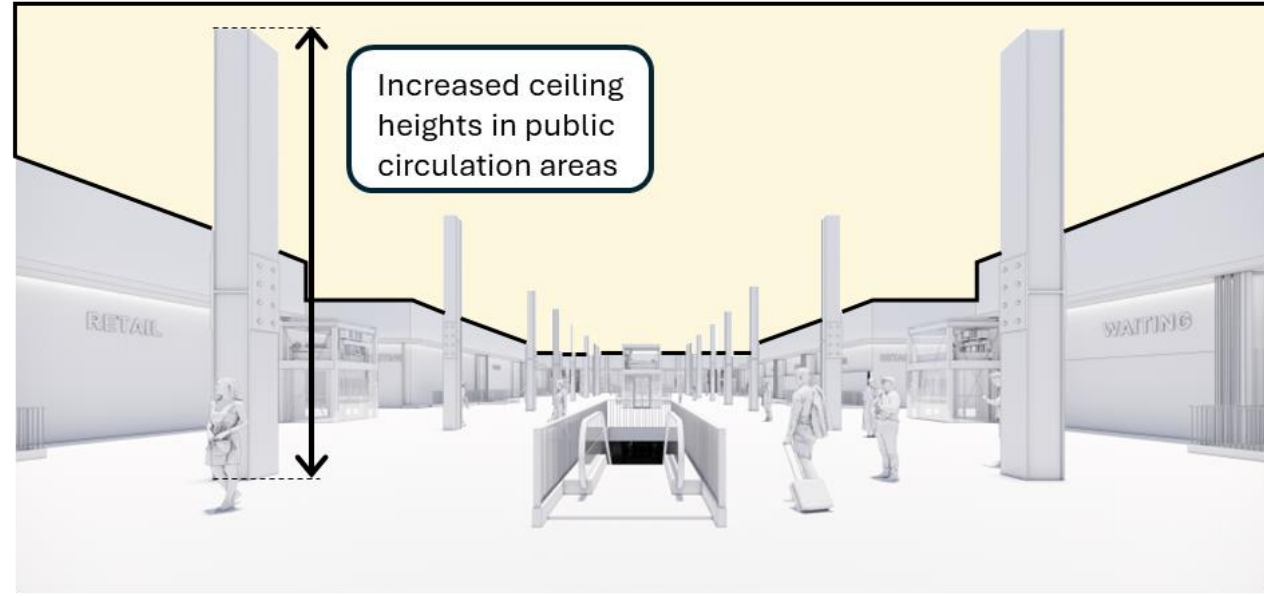

Rationalized concourse layouts informed by street grids, significantly aiding wayfinding

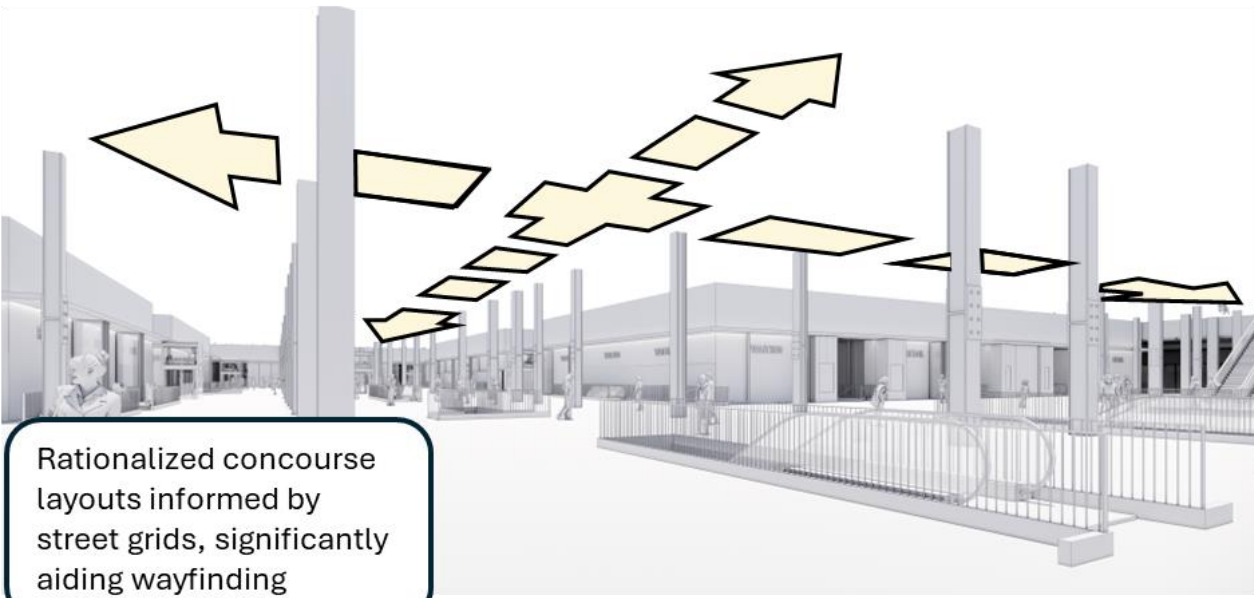

Increased number of clearly legible vertical circulation elements to platforms

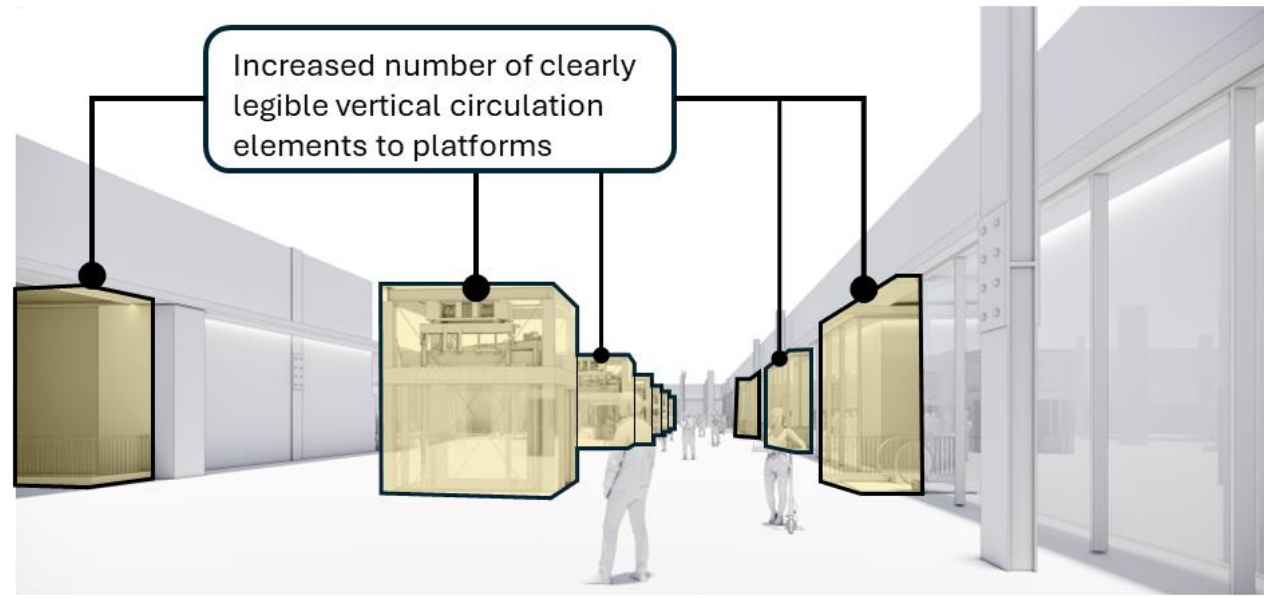

Proposed Entrance Improvements

- Large canopies clearly **identifying Station entrances**
- Clear sightlines from interior to street to **improve orientation and wayfinding**
- Provide **7 ADA accessible entrances** from Station concourses to street level
- Additional stairs and escalators to **improve pedestrian flow and emergency egress**
- **Daylighting** of underground Station
- Integrated **modern mechanical equipment** to improve Station environment



Proposed Entrance Improvements

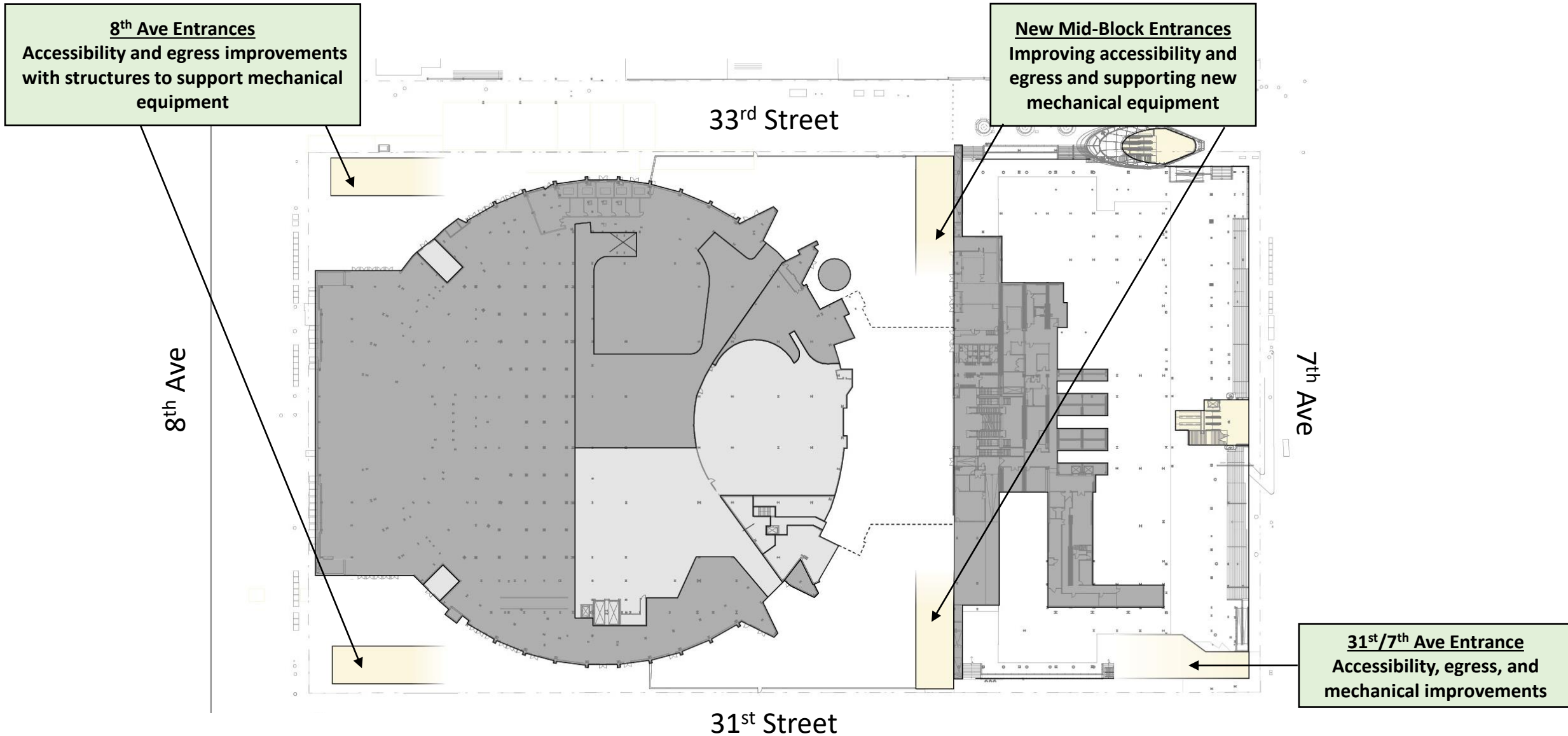

Project Purpose and Goals

Draft for Public Comment

Project Purpose:

To improve safety, functionality, and overall customer experience within existing Penn Station

Project Goals:

Enhance safety

by improving platform accessibility and egress, modernizing critical fire-life safety systems, and increasing ceiling heights

Elevate the customer experience

by enhancing the station's visibility and accessibility, widening and modernizing concourses, and introducing daylight where possible

Upgrade building systems

to improve performance, efficiency, and sustainability

Improve station operations

by modernizing and consolidating railroad support spaces

Optimize project delivery

by minimizing construction impacts to customers, construction duration, and project costs

The full list of project draft goals and objectives will be included in a draft purpose and need document, which will become available on the project website: <https://pennstationcomplex.info/>



Preliminary illustrative image

An aerial photograph of a city, likely Philadelphia, with a blue overlay. The image shows a dense urban area with a river (the Schuylkill River) winding through it. The text is overlaid on the left side of the image.

PENN PROJECTS PRELIMINARY TIMELINES

Penn Projects Preliminary Timelines

Illustrative preliminary timelines – subject to change

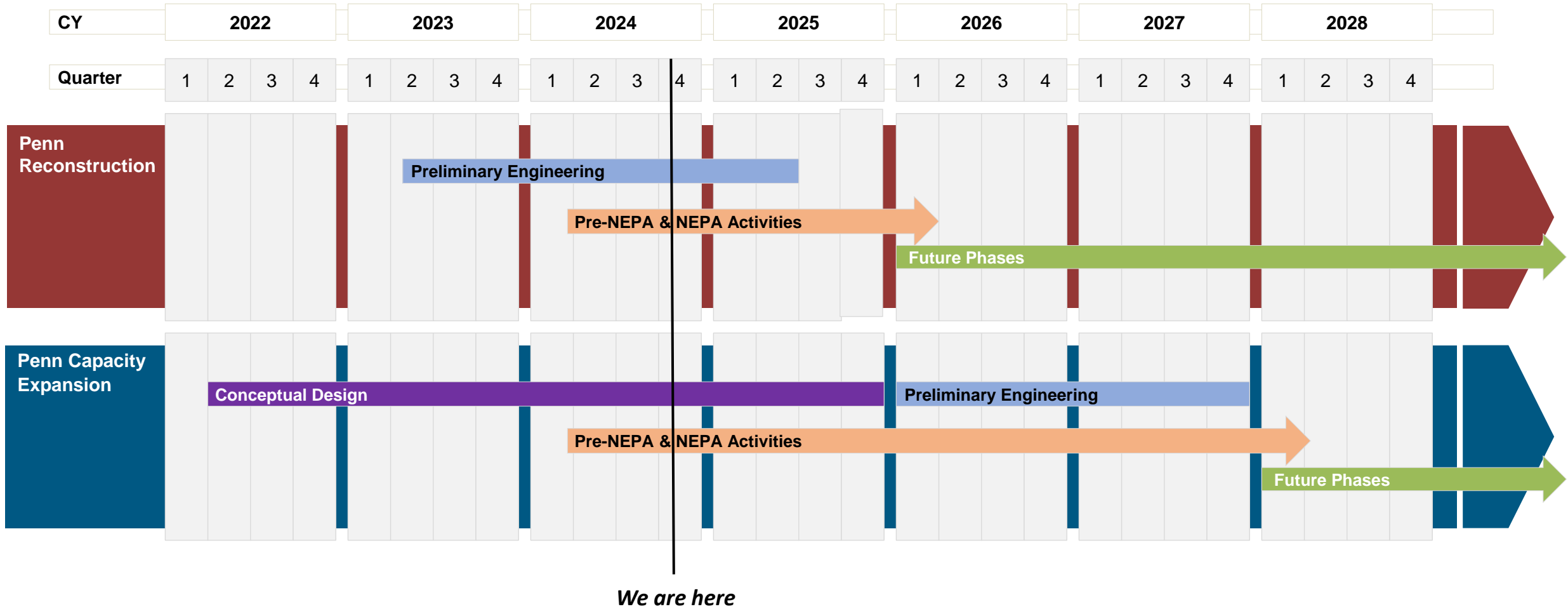

Federal Discretionary Grant Awards

Will provide funding for both Penn Projects' environmental review and preliminary engineering activities



New York – New York Penn Station Reconstruction (Up to \$72,548,687)

New York Metropolitan Transportation Authority

The proposed project is for project development activities to renovate and modernize New York Penn Station in New York City. Scope elements include environmental review and other project development activities to support the reconstruction of Penn Station New York. This project will enable safer and more efficient station operations by increasing concourse capacity and access both within and outside the station, improving ventilation and fire safety, and installing user-friendly wayfinding. The result will be a reduction in the state of good repair backlog along the Northeast Corridor.

New York – Gateway: New York Penn Station Capacity Expansion (Up to \$71,977,500)

Amtrak

The proposed project is for project development activities in support of expanding the track and platform capacity of New York Penn Station in New York City. Scope elements include environmental review and other project development activities to support the capacity expansion of Penn Station New York. This project will boost capacity and expand services for passengers, including the addition of track and platforms, concourses, and amenities. The result will accommodate projected demand and capitalize on the additional capacity enabled by the Gateway Program of projects, including the additional track capacity from the Hudson Tunnel Project.

DISCUSSION

Provide Feedback



An aerial photograph of a city, likely New York City, showing a river (the Hudson River) and a dense urban area. The image is overlaid with a semi-transparent blue filter. The text 'STATION TOUR' is prominently displayed in white, bold, uppercase letters on the left side of the image.

STATION TOUR